

April 30, 2015

Mr. Larry Henson  
Louisiana Economic Development (LED)  
1051 North Third St.  
Baton Rouge, LA 70802-5239

Mr. David Conner  
Southwest Economic Development Alliance (SWLA)  
P.O. Box 3110  
Lake Charles, LA 70602

RE: B85-Chennault Site 5 (160 Acres)  
Topographic Survey & Floodplain Designation

Dear Gentlemen:

SJB Group, LLC (SJB) has been authorized by Louisiana Economic Development (LED and Southwest Louisiana Economic Alliance (SWLA) to perform due diligence investigations to determine the existence of fatal flaws, if any, that would inhibit the development of Chennault Site 5 (+/- 160 acres), located southeast of the City of Lake Charles in Calcasieu Parish, Louisiana.

The latest available FEMA Flood Insurance Rate Maps (FIRM) were utilized to determine the approximate location of flood zone boundaries for the subject tract. The FIRM was overlaid on the tract along with available GIS information to determine an approximate amount of fill required to elevate the site to the Base Flood Elevation (BFE). Currently, the southern portion of the tract lies within the floodplain limits and is located in Flood Zone "A" with no BFE determined.

A flood zone determination was obtained from the Army Corps of Engineers to determine a BFE of 16 feet. Available GIS information shows existing contours ranging in elevation from 11 feet to 16 feet. Based on this data SJB Group identified a Development Area (within the larger 160 acre parcel) of approximately 80 acres that would not require any additional fill material. The location of the proposed Development Area is shown in the enclosed exhibit.

Please feel free to contact me at (225) 769-3400, at any time, should you have any questions or need further information.

Sincerely,

**SJB GROUP, LLC**

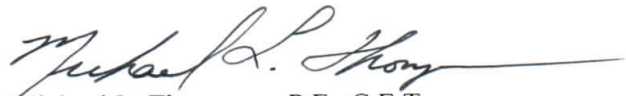
  
Michael L. Thompson, P.E., C.E.T.  
Engineering Department Manager

Parks & Planning

Transportation

Site Development

Utility Systems

Land Surveying

Construction Services

Environmental Services

Real Estate Services

P. O. Box 1751

Baton Rouge, Louisiana

70821-1751

(225) 769-3400

Fax (225) 769-3596

www.sjbgroup.com



Exhibit S - Base Flood Elevation ( BFE) Map



Calcasieu Parish

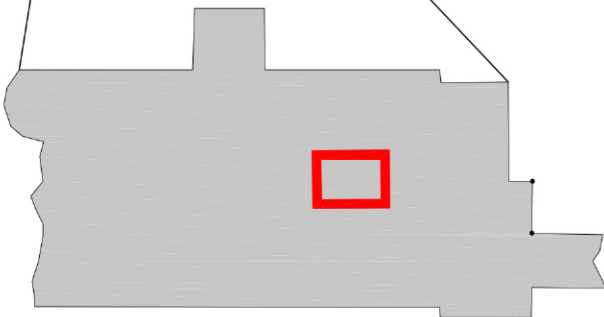

Available Site Data

- Chennault Site 5
- Development Tract
- Existing Contours
- Flood Zone "A"  
BFE = 16.0'

Source:  
- Aerial Photo: 2014 Google Earth  
- Site Boundaries are Approximate  
- 12/10/2014  
- Flood Information from FIRM 22019C0485F  
dated February 18, 2011

