



Colliers

Accelerating success.

FOR SALE OR LEASE

Asking Price:

\$4.25M

Lease Rate:

\$4.95

PSF, NNN

Contact us:

Clark Irwin, CCIM, SIOR

+1 501 978 6588

clark.irwin@colliers.com

Isaac Smith, CCIM, SIOR

+1 501 850 0736

isaac.smith@colliers.com

1 Allied Drive, Suite 1500,
Little Rock, AR 72202

P: +1 501 372 6161

colliers.com/arkansas

9908 I-30, Little Rock, AR

**For Sale or Lease: I-30 Frontage
Industrial Building**

Features

- Total building size: 77,128 SF
- Warehouse: 54,000 SF
- Retail/warehouse: 22,000 SF
- Office: 1,152 SF
- Lot size: 5.61 acres
- Sale price: \$4,250,000
- Lease rate: \$4.95/SF, NNN
- Ceiling height: 17'8" - 24'6"
- 15 dock-high doors
- One drive-in door
- Zoned: C-4
- Monument signage on property

Copyright © 2024 Colliers International.

Information herein has been obtained from sources deemed reliable, however its accuracy cannot be guaranteed. The user is required to conduct their own due diligence and verification.

Neighborhood Map

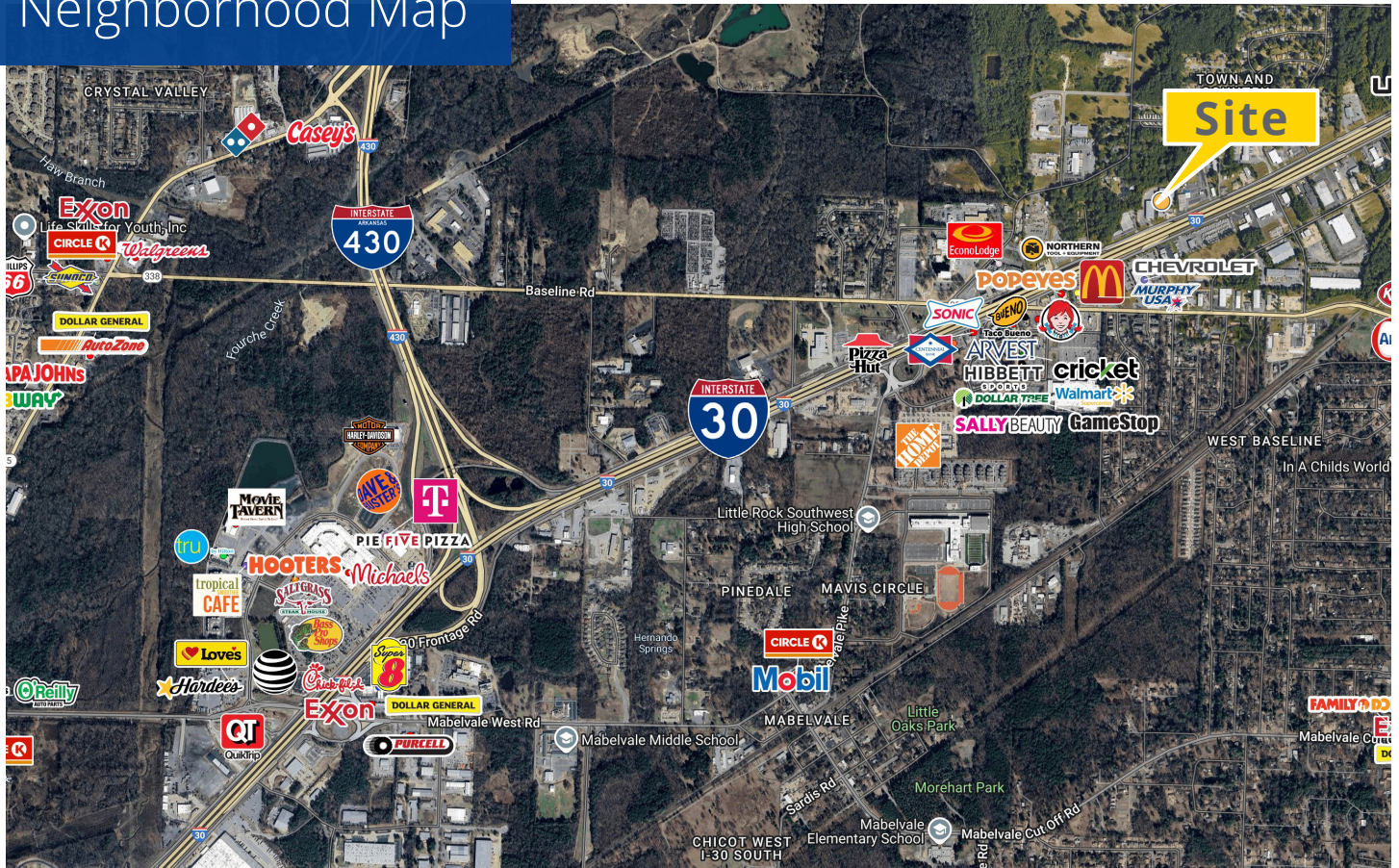

Contact us:

Clark Irwin, CCIM, SIOR
+1 501 978 6588
clark.irwin@colliers.com

Isaac Smith, CCIM, SIOR
+1 501 850 0736
isaac.smith@colliers.com

1 Allied Drive, Suite 1500,
Little Rock, AR 72202
P: +1 501 372 6161
colliers.com/arkansas

Floor Plan

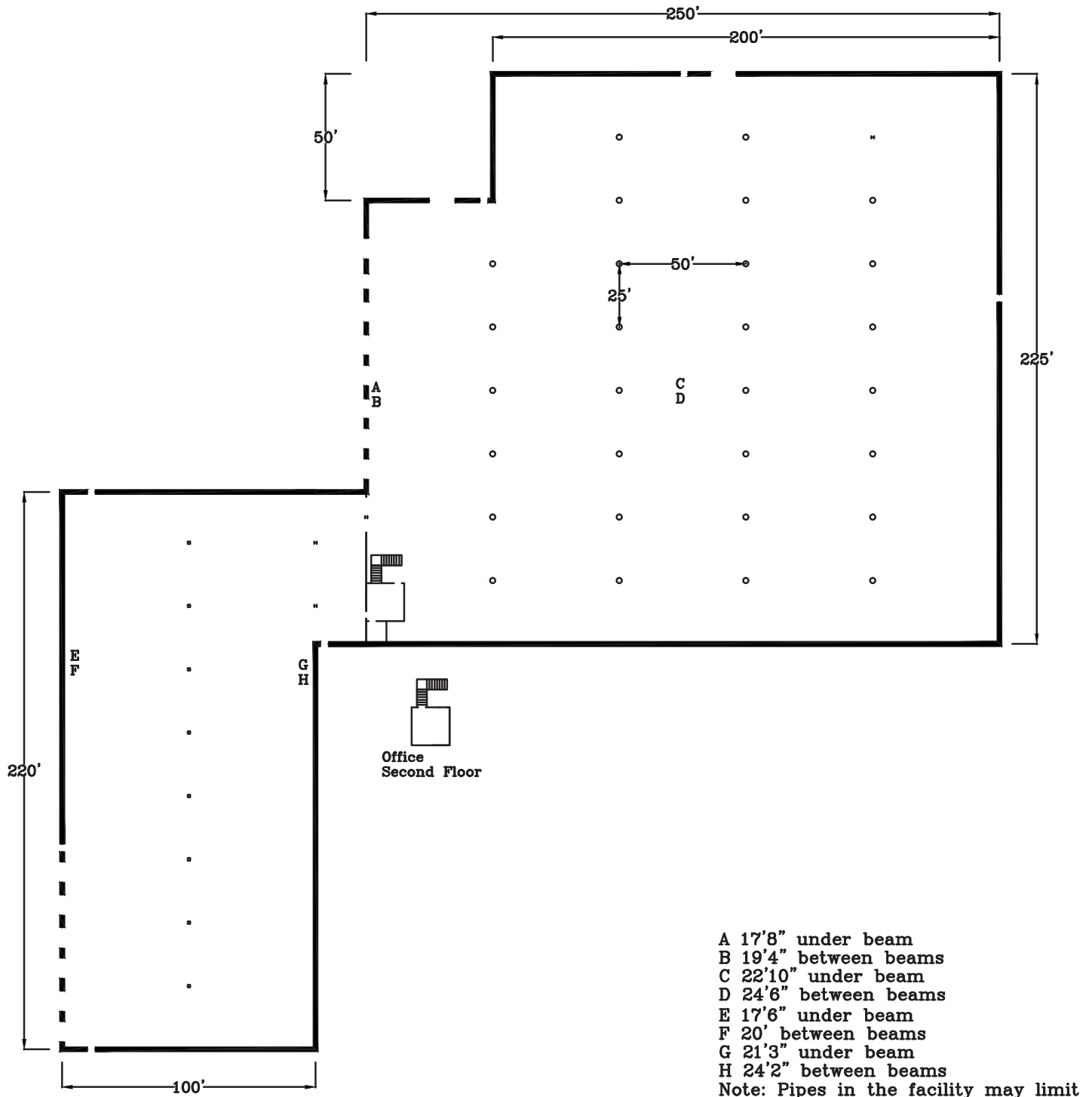

Contact us:

Clark Irwin, CCIM, SIOR
 +1 501 978 6588
 clark.irwin@colliers.com

Contact us:

Isaac Smith, CCIM, SIOR
 +1 501 850 0736
 isaac.smith@colliers.com

1 Allied Drive, Suite 1500,
 Little Rock, AR 72202
 P: +1 501 372 6161
 colliers.com/arkansas