

BUILDING LEASE PLAN

JAMES W. HUGGINS, ARCHITECT, AIA
 2412 PERDUE STREET, SUITE 8
 MONROE, LOUISIANA 71201

14,400 sq ft.
 available

JAMES W. HUGGINS, ARCHITECT, AIA
2412 FERRAND STREET, SUITE B
MONROE, LOUISIANA 71201

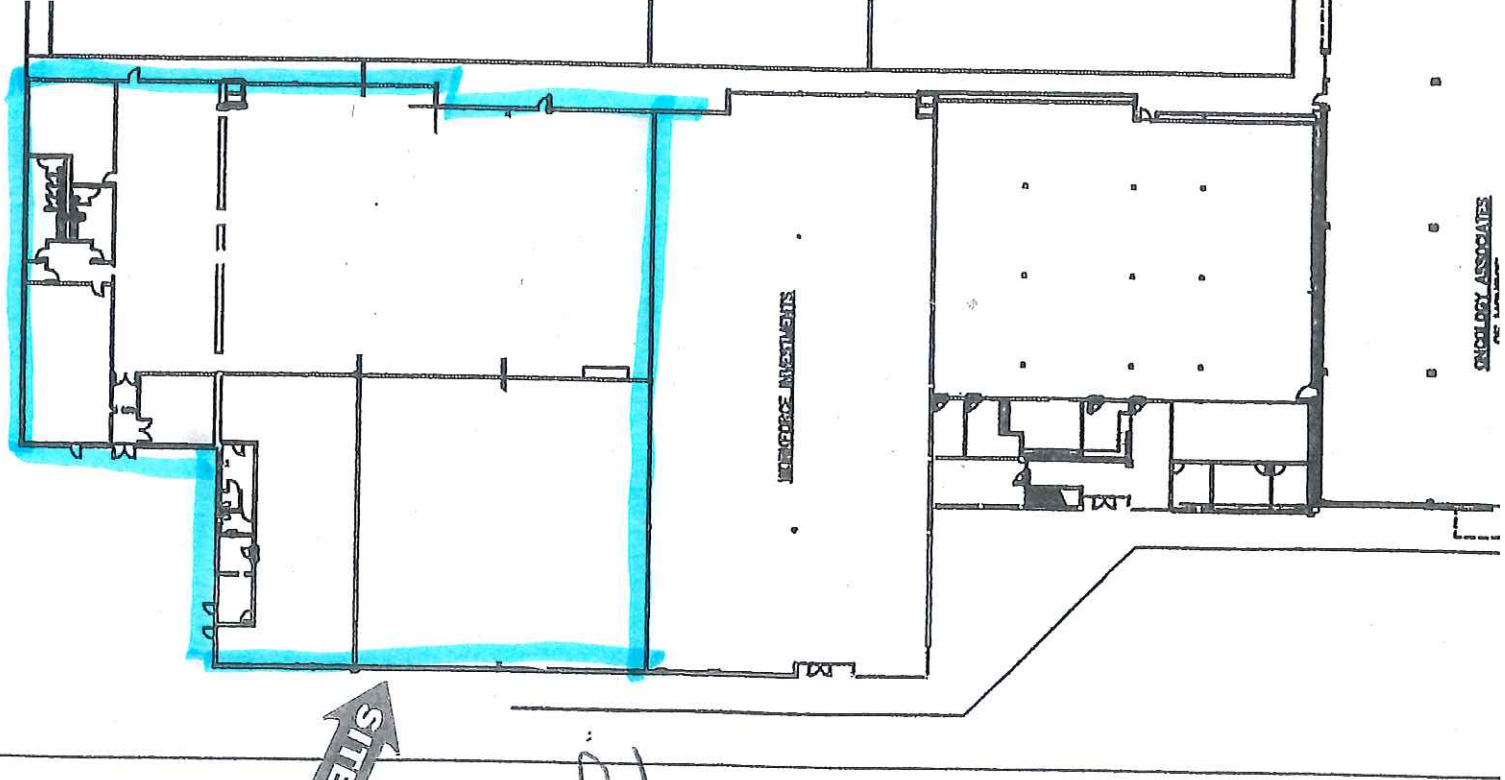

ENCLOSURE ASSOCIATES
PER 10/1/2000

14,400 sq ft.
AVAILABLE