

Exhibit CC. Tamanend Business Park East Site U.S.A.C.E. Jurisdictional Determination





DEPARTMENT OF THE ARMY
NEW ORLEANS DISTRICT, CORPS OF ENGINEERS
P.O. BOX 60267
NEW ORLEANS, LOUISIANA 70160-0267

REPLY TO
ATTENTION OF

JAN 10 2014

Operations Division
Surveillance and Enforcement Section

Mr. Michael Henry
Hydrik Wetland and GIS Consultants
604 W. Charles Street
Hammond, Louisiana 70401

**Tamanend Business Park East Site
U.S.A.C.E. Jurisdictional Determination**

Dear Mr. Henry:

Reference is made to your request, on behalf of WREDCO, for a U.S. Army Corps of Engineers' (Corps) jurisdictional determination on property located in Sections 4 and 9, Township 8 South, Range 13 East, St. Tammany Parish, Louisiana (enclosed map). Specifically, this property is identified as an 856.2-acre site on and east of LA Highway 434.

Based on review of recent maps, aerial photography, soils data, a previous determination, and information provided with your request, we have determined that part of the property is wetland and subject to Corps' jurisdiction. The approximate limits of the wetland are designated in red on the map. A Department of the Army (DA) permit under Section 404 of the Clean Water Act will be required prior to the deposition or redistribution of dredged or fill material into this wetland. Additionally, a DA permit will be required if you propose to deposit dredged or fill material into Big Branch on the property (shown in blue on the map).

You and your client are advised that this approved jurisdictional determination is valid for a period of 5 years from the date of this letter unless new information warrants revision prior to the expiration date or the District Commander has identified, after public notice and comment, that specific geographic areas with rapidly changing environmental conditions merit re-verification on a more frequent basis.

Should there be any questions concerning these matters, please contact Mr. Bill Nethery at (504) 862-1267 and reference our Account No. MVN 2013-02453-SQ. If you have specific questions regarding the permit process or permit applications, please contact our Eastern Evaluation Section at (504) 862-2292. The New Orleans District Regulatory Branch is committed to providing quality and timely service to our customers. In an effort to improve customer service, please complete the survey on our web site at <http://per2.nwp.usace.army.mil/survey.html>.

Sincerely,

 Martin S. Mayer
Chief, Regulatory Branch

Enclosures

WREDCO
 LA. HWY 434
 MVN 2007 1686 SQ
 JD EXTENSION REQUEST AND
 ADDITIONAL TRACT JD REQUEST
 SITE TOTAL ~856.26 ACRES



APPROVED
 JURISDICTIONAL DETERMINATION

USACE

FSV / *11H* Date: *1-3-14*
 Botanist: *William Nethery*
 Requestor: *Michael Henry for WREDCO*
 # *MVN-2013-02453-SR*
 [Red Hatched Box] - WETLAND
 [Green Box] - NON-WETLAND
 [Blue Box] - *Waters of the US (404)*

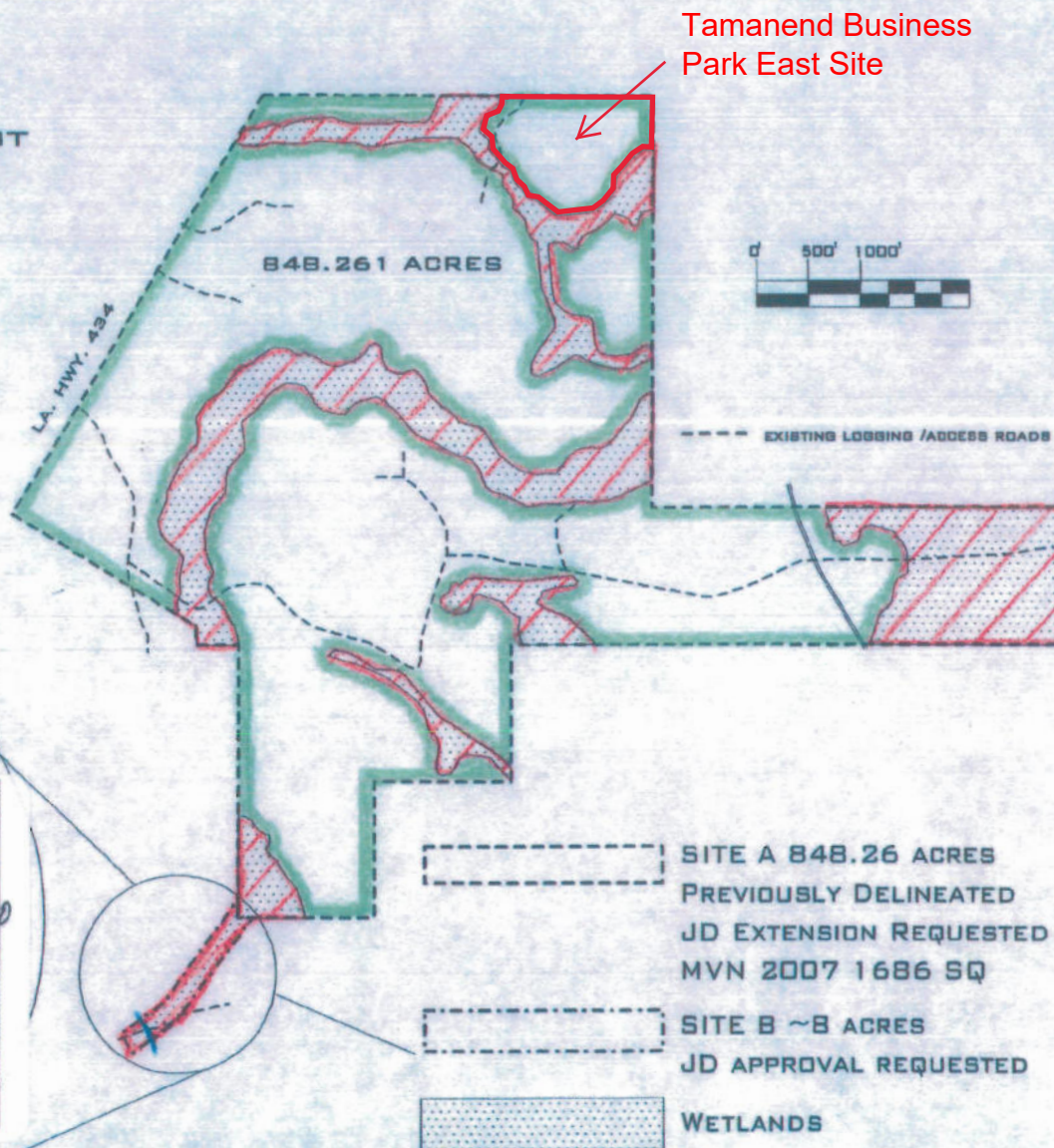

WREDCO ST. TAMMANY PARISH, LA ~856.26 ACRES	
FILE: 13476c	DATE: 09 17 13
FIGURE: DELINEATION MAP	REV:
DRAWING: PV	APPROVED: MJH